

### Features

- High Current application.
- Ferrite core construction.
- Magnetically shielded.
- RoHS compliance.

### Applications

- Ideally used in Digital amplifier filter in Car radio, Home theater and large LCD etc..

### Shapes and Dimensions

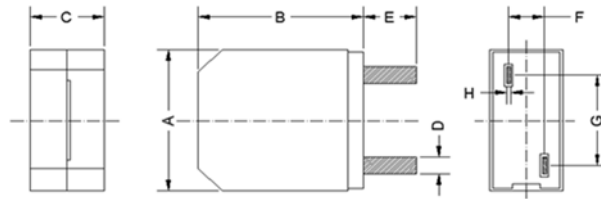

Type	A	B	C	D	E	F	G	H
DEP1416	14.5 Max.	16.0 Max.	10.2 Max.	1.8 ref.	5.0 ± 0.5	4.5 ± 0.5	9.0 ± 0.5	0.35-0.65

### Electrical Characteristics

Part Number	Inductance (uH)	Measuring Freq. (KHz)	D.C.R ( Ω ) max.	Isat (A) max.	Irms (A) max.
DEP1416-5R0M	5.0 ± 20%	1	5.1	18.50	14.20
DEP1416-100M	10.0 ± 20%	1	9.1	13.50	11.70
DEP1416-150M	15.0 ± 20%	1	9.5	8.50	11.20
DEP1416-180M	18.0 ± 20%	1	10.1	7.90	9.60
DEP1416-220M	22.0 ± 20%	1	11.4	7.30	8.50
DEP1416-270M	27.0 ± 20%	1	13.8	6.50	7.70
DEP1416-330M	33.0 ± 20%	1	15.0	5.90	7.20

#### NOTES:

Isat: DC current at which the inductance drops approximately 30% from its value without current.

Irms: DC current that causes the temperature rise (ΔT=40°C) from 20°C ambient