

Features

- Low cost, wide range of inductance.
- Small mounting space required.
- Low DCR, large current, best for the power supply line.
- Lead-Free, Halogen-Free and RoHS compliant.

Applications

- Switching power supply, DC-DC converters, TVs, VTRs, OA equipments choke, Home electric appliance, etc..

Shapes and Dimensions

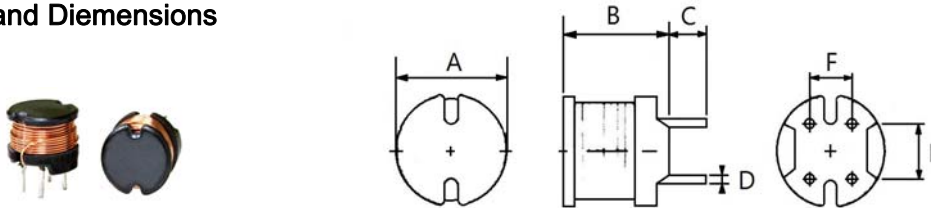

| Type | A | B | C | D | E | F | | |
|--------|-----------|----------|-----------|------------|-----------|-----------|--|--|
| RCH108 | 10.0 max. | 8.5 max. | 3.5 ± 1.0 | 0.70 ± 0.1 | 5.0 ± 0.3 | 4.0 ± 0.3 | | |

Electrical Characteristics

| Part No. | Inductance (μH) | Measuring Frequency | D.C.R (Ω) Max. | Rated Current (A) Max. |
|-------------|-----------------|---------------------|----------------|------------------------|
| RCH108-2R2M | 2.2 ± 20% | 7.96 MHz | 0.009 | 7.90 |
| RCH108-2R7M | 2.7 ± 20% | 7.96 MHz | 0.010 | 7.20 |
| RCH108-3R7M | 3.7 ± 20% | 7.96 MHz | 0.011 | 6.30 |
| RCH108-4R7M | 4.7 ± 20% | 7.96 MHz | 0.012 | 5.70 |
| RCH108-6R2M | 6.2 ± 20% | 7.96 MHz | 0.015 | 5.30 |
| RCH108-8R2M | 8.2 ± 20% | 7.96 MHz | 0.017 | 5.00 |
| RCH108-100M | 10 ± 20% | 1 KHz | 0.027 | 4.50 |
| RCH108-120M | 12 ± 20% | 1 KHz | 0.031 | 4.10 |
| RCH108-150M | 15 ± 20% | 1 KHz | 0.036 | 3.70 |
| RCH108-180M | 18 ± 20% | 1 KHz | 0.049 | 3.40 |
| RCH108-220M | 22 ± 20% | 1 KHz | 0.055 | 3.10 |
| RCH108-270M | 27 ± 20% | 1 KHz | 0.062 | 2.80 |
| RCH108-330M | 33 ± 20% | 1 KHz | 0.079 | 2.50 |
| RCH108-390M | 39 ± 20% | 1 KHz | 0.087 | 2.30 |
| RCH108-470M | 47 ± 20% | 1 KHz | 0.099 | 2.10 |
| RCH108-560M | 56 ± 20% | 1 KHz | 0.130 | 1.90 |
| RCH108-680M | 68 ± 20% | 1 KHz | 0.140 | 1.70 |
| RCH108-820M | 82 ± 20% | 1 KHz | 0.160 | 1.60 |
| RCH108-101K | 100 ± 10% | 1 KHz | 0.210 | 1.40 |
| RCH108-121K | 120 ± 10% | 1 KHz | 0.240 | 1.30 |
| RCH108-151K | 150 ± 10% | 1 KHz | 0.320 | 1.20 |
| RCH108-181K | 180 ± 10% | 1 KHz | 0.350 | 1.10 |
| RCH108-221K | 220 ± 10% | 1 KHz | 0.450 | 0.96 |
| RCH108-271K | 270 ± 10% | 1 KHz | 0.610 | 0.87 |
| RCH108-331K | 330 ± 10% | 1 KHz | 0.690 | 0.79 |
| RCH108-391K | 390 ± 10% | 1 KHz | 0.780 | 0.72 |
| RCH108-471K | 470 ± 10% | 1 KHz | 1.000 | 0.66 |
| RCH108-561K | 560 ± 10% | 1 KHz | 1.200 | 0.60 |
| RCH108-681K | 680 ± 10% | 1 KHz | 1.400 | 0.55 |
| RCH108-821K | 820 ± 10% | 1 KHz | 1.800 | 0.50 |
| RCH108-102K | 1,000 ± 10% | 1 KHz | 2.100 | 0.45 |

NOTES:

Rated current : The DC current at which the inductance decrease to 90% from its initial value or when Δt=40°C whichever is lower (Ta=20°C)