

Features

- Excellent solderability and high heat resistance.
- Takes up less PCB real estate and save more power
- Packed in carrier tape and suitable for Surface Mounting Machine.
- Magnetic shielded type against radiation

Applications

- Ideally used in Notebook PC, LCD TV, Game machine, STB, Projector etc. as DC-DC convertor inductors.

Shapes and Dimensions

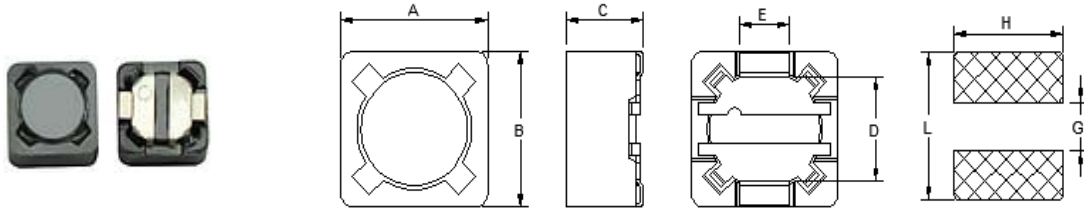

Packing Q'ty : 1,000 pcs/reel

Type	A	B	C	D	E	L	G	H
SDRH73	7.3 ± 0.3	7.3 ± 0.3	4.5 Max.	5.4 ± 0.2	1.8	8.0	4.8	2.2

Electrical Characteristics

Part Number	Inductance (uH)	Measuring Freq. (KHz)	D.C.R (Ω) max.	Rated Current (A) max.
SDRH74-1R0NC	1.0 ± 30%	100	0.015	9.00
SDRH74-1R5NC	1.5 ± 30%	100	0.180	7.00
SDRH74-2R2NC	2.2 ± 30%	100	0.028	6.00
SDRH74-3R3NC	3.3 ± 30%	100	0.032	4.80
SDRH74-3R9NC	3.9 ± 30%	100	0.035	4.40
SDRH74-4R7NC	4.7 ± 30%	100	0.038	4.00
SDRH74-5R6NC	5.6 ± 30%	100	0.040	3.50
SDRH74-6R8NC	6.8 ± 30%	100	0.045	3.00
SDRH74-100NC	10 ± 30%	100	0.049	1.84
SDRH74-120MC	12 ± 20%	100	0.058	1.71
SDRH74-150MC	15 ± 20%	100	0.081	1.47
SDRH74-180MC	18 ± 20%	100	0.091	1.31
SDRH74-220MC	22 ± 20%	100	0.110	1.23
SDRH74-270MC	27 ± 20%	100	0.150	1.12
SDRH74-330MC	33 ± 20%	100	0.170	0.96
SDRH74-390MC	39 ± 20%	100	0.230	0.91
SDRH74-470MC	47 ± 20%	100	0.260	0.88
SDRH74-560MC	56 ± 20%	100	0.350	0.80
SDRH74-680MC	68 ± 20%	100	0.380	0.70
SDRH74-820MC	82 ± 20%	100	0.430	0.61
SDRH74-101MC	100 ± 20%	100	0.610	0.60
SDRH74-121MC	120 ± 20%	100	0.660	0.52
SDRH74-151MC	150 ± 20%	100	0.880	0.46
SDRH74-181MC	180 ± 20%	100	0.980	0.42
SDRH74-221MC	220 ± 20%	100	1.170	0.36
SDRH74-271MC	270 ± 20%	100	1.640	0.34
SDRH74-331MC	330 ± 20%	100	1.860	0.32
SDRH74-391MC	390 ± 20%	100	2.850	0.29
SDRH74-471MC	470 ± 20%	100	3.010	0.26
SDRH74-561MC	560 ± 20%	100	3.620	0.23
SDRH74-681MC	680 ± 20%	100	4.630	0.22
SDRH74-821MC	820 ± 20%	100	5.200	0.20
SDRH74-102MC	1,000 ± 20%	100	6.000	0.18

NOTES:

Isat: DC current at which the inductance drops approximately 35% from its value without current.

Irms: DC current that causes the temperature rise (ΔT=40°C) from 20°C ambient