

Features

- Low cost, wide range of inductance.
- Small mounting space required.
- Low DCR, large current, best for the power supply line.
- Lead-Free, Halogen-Free and RoHS compliant.

Applications

- Switching power supply, DC-DC converters, TVs, VTRs, OA equipments choke, Home electric appliance, etc..

Shapes and Dimensions

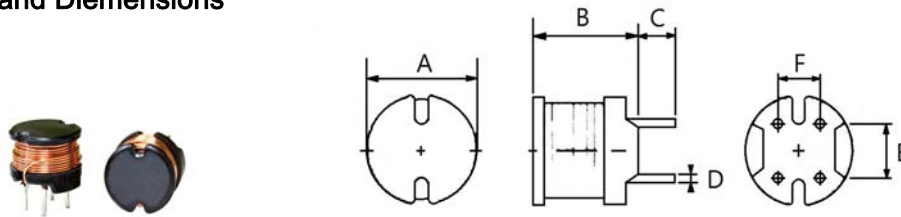

Type	A	B	C	D	E	F	G
RCH110	10.0 max.	10.5 max.	3.5 ± 1.0	0.70 ± 0.1	5.0 ± 0.3	4.0 ± 0.3	

Electrical Characteristics

Part No.	Inductance (μH)	Measuring Frequency	D.C.R (Ω) Max.	Rated Current (A) Max.
RCH110-100M	10 ± 20%	1 KHz	0.022	5.30
RCH110-120M	12 ± 20%	1 KHz	0.023	4.90
RCH110-150M	15 ± 20%	1 KHz	0.026	4.40
RCH110-180M	18 ± 20%	1 KHz	0.033	4.00
RCH110-220M	22 ± 20%	1 KHz	0.037	3.60
RCH110-270M	27 ± 20%	1 KHz	0.048	3.30
RCH110-330K	33 ± 10%	1 KHz	0.055	2.90
RCH110-390K	39 ± 10%	1 KHz	0.073	2.70
RCH110-470K	47 ± 10%	1 KHz	0.083	2.50
RCH110-560K	56 ± 10%	1 KHz	0.092	2.30
RCH110-680K	68 ± 10%	1 KHz	0.120	2.10
RCH110-820K	82 ± 10%	1 KHz	0.140	1.90
RCH110-101K	100 ± 10%	1 KHz	0.160	1.70
RCH110-121K	120 ± 10%	1 KHz	0.200	1.50
RCH110-151K	150 ± 10%	1 KHz	0.230	1.40
RCH110-181K	180 ± 10%	1 KHz	0.310	1.30
RCH110-221K	220 ± 10%	1 KHz	0.340	1.10
RCH110-271K	270 ± 10%	1 KHz	0.400	1.00
RCH110-331K	330 ± 10%	1 KHz	0.520	0.93
RCH110-391K	390 ± 10%	1 KHz	0.650	0.86
RCH110-471K	470 ± 10%	1 KHz	0.710	0.78
RCH110-561K	560 ± 10%	1 KHz	1.000	0.71
RCH110-681K	680 ± 10%	1 KHz	1.100	0.65
RCH110-821K	820 ± 10%	1 KHz	1.300	0.59
RCH110-102K	1,000 ± 10%	1 KHz	1.700	0.53

NOTES:

Rated current : The DC current at which the inductance decrease to 90% from its initial value or when Δt=40°C whichever is lower (Ta=20°C)