

Features

- High Current application.
- Ferrite core construction.
- Magnetically shielded.
- RoHS compliance.

Applications

- Ideally used in Digital amplifier filter in Car radio, Home theater and large LCD etc..

Shapes and Dimensions

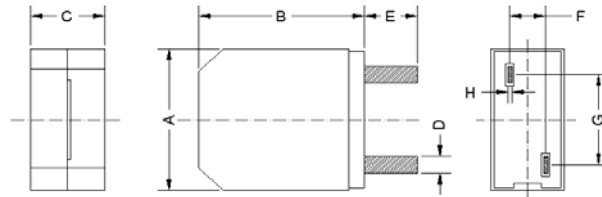

Type	A	B	C	D	E	F	G	H
DEP1315	13.5 Max.	15.0 Max.	7.0 Max.	1.8 ref.	5.0 ± 0.5	3.3 ± 0.5	8.4 ± 0.5	0.30-0.60

Electrical Characteristics

Part Number	Inductance (uH)	Measuring Freq. (KHz)	D.C.R (Ω) max.	Isat (A) max.	Irms (A) max.
DEP1315-4R7M	4.7 ± 20%	1	5.4	17.00	11.60
DEP1315-5R6M	5.6 ± 20%	1	6.3	14.50	11.00
DEP1315-8R2M	8.2 ± 20%	1	9.6	12.50	7.80
DEP1315-100M	10.0 ± 20%	1	10.5	10.50	7.40
DEP1315-120M	12.0 ± 20%	1	17.5	10.00	5.90
DEP1315-150M	15.0 ± 20%	1	19.0	9.00	5.60
DEP1315-180M	18.0 ± 20%	1	20.2	8.30	5.40
DEP1315-220M	22.0 ± 20%	1	21.5	7.00	5.20

NOTES:

Isat: DC current at which the inductance drops approximately 30% from its value without current.

Irms: DC current that causes the temperature rise ($\Delta T=40^{\circ}\text{C}$) from 20°C ambient